

! We suggest to use 2x shim in a total thickness of 0.25mm-0.35mm combined together.
 Note: Adjust depending on the engine conditions, fuel and altitude.

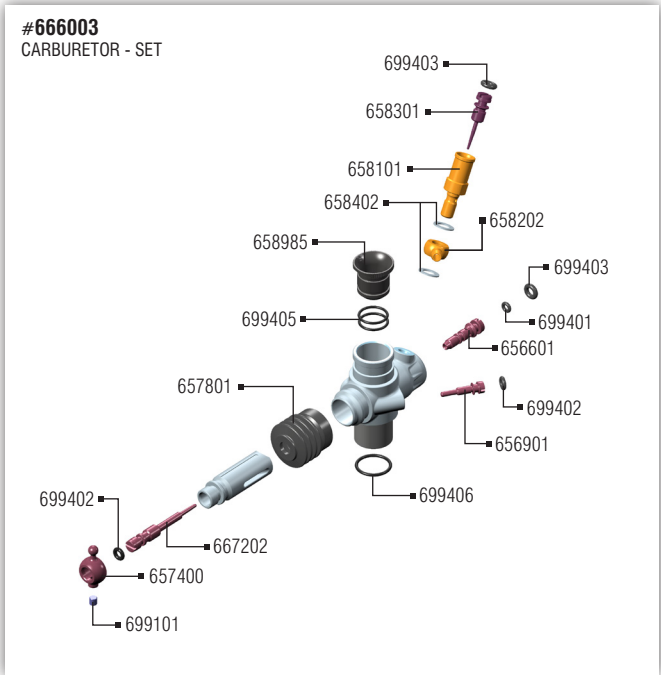
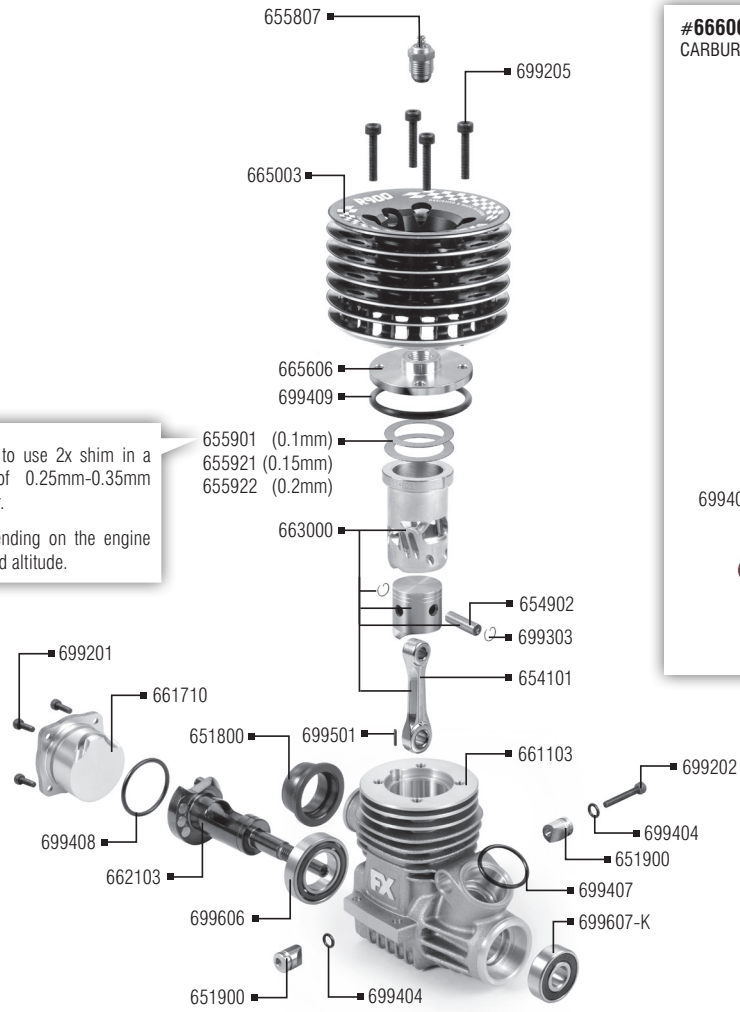

CARBURETOR SETTINGS

Factory carburetor setting for break-in procedure

The carburetor comes preset from factory and you have to start the break-in procedure with the following setting:

1 Main High-speed Needle (Upper)	approx. 0.8mm inside the needle body
2 Low-end Needle (Front)	approx. 0.8mm inside the needle body
3 Idle Adjustment Screw	Size measured with carburetor boot compressed approx. 54.2mm

Basic Carburetor Setting after break-in procedure

After you have finished the break-in procedure this is the basic carburetor setting. Any time you get lost return back to this basic setting.

1 Main High-speed Needle (Upper)	approx. 0.8mm inside the needle body
2 Low-end Needle (Front)	approx. 0.8mm inside the needle body
3 Idle Adjustment Screw	Size measured with carburetor boot compressed approx. 53.2mm

