

**No. Engine**

661103.3-233341

**INCLUDED ENGINE HEAD SHIM**

655901	0.10mm	
655921	0.15mm	
655922	0.20mm	

**INCLUDED SHIM UNDER SLEEVE**

653900	0.10mm	
	0.15mm	
	0.20mm	
WITHOUT	0.00mm	

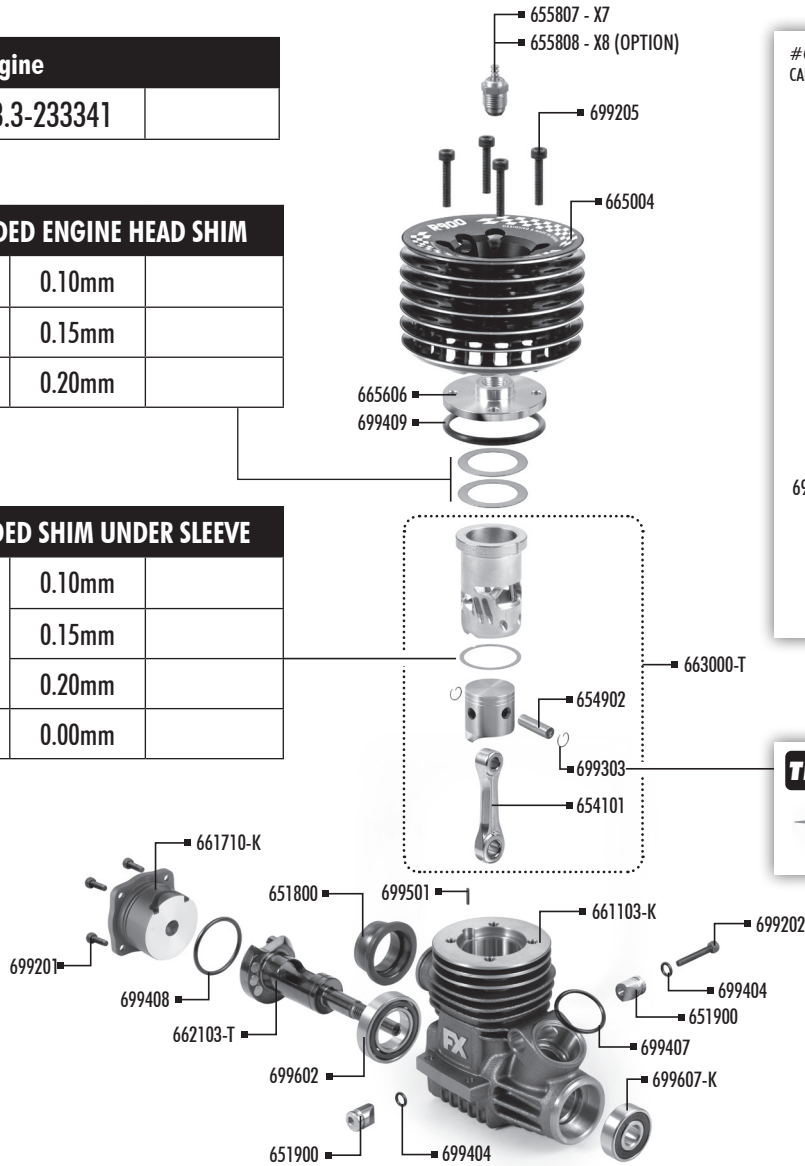

**#666003-K  
CARBURETOR - SET**

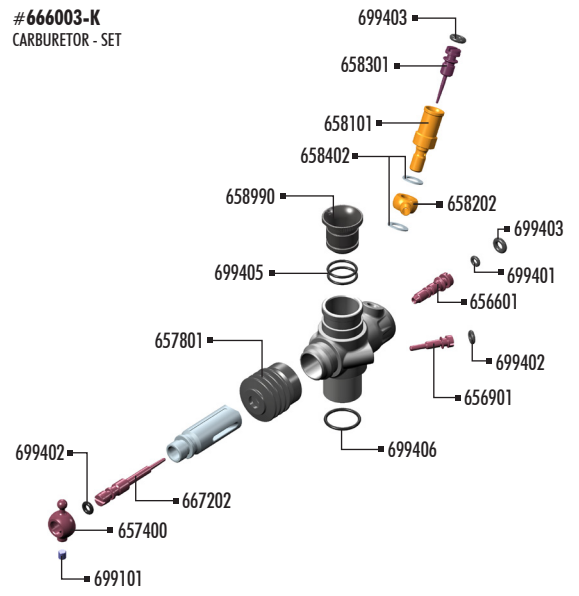

**TIP** Use #107680 - HUDY Engine C-clip Removal Tool to remove the C-clip from the engine.



**CARBURETOR SETTINGS**

**Factory carburetor setting for break-in procedure**

The carburetor comes preset from factory and you have to start the break-in procedure with the following setting:

<b>1</b> Main High-speed Needle (Upper)	approx. 0.8mm inside the needle body
<b>2</b> Low-end Needle (Front)	approx. 0.6mm inside the needle body
<b>3</b> Idle Adjustment Screw	Size measured with carburetor boot compressed approx. 54.2mm

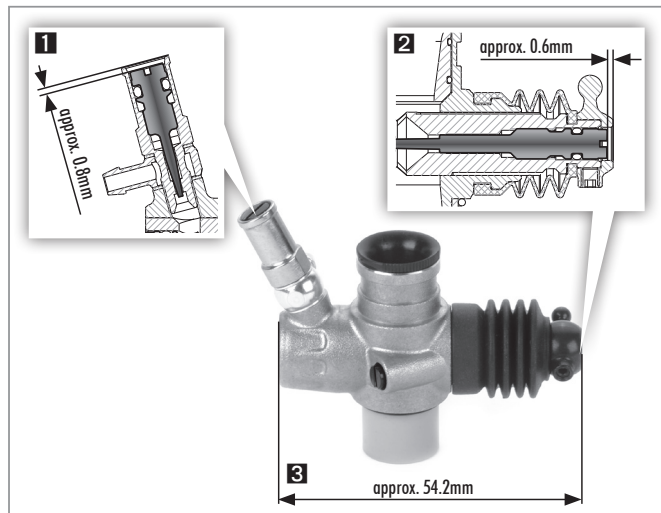

**Basic Carburetor Setting after break-in procedure**

After you have finished the break-in procedure this is the basic carburetor setting. Any time you get lost return back to this basic setting.

<b>1</b> Main High-speed Needle (Upper)	approx. 0.8mm inside the needle body
<b>2</b> Low-end Needle (Front)	approx. 0.6mm inside the needle body
<b>3</b> Idle Adjustment Screw	Size measured with carburetor boot compressed approx. 53.2mm

